



**Viewing Information**

This photograph and visualisation is a cylindrical projection panorama. Hold this sheet at a comfortable arm's length from your eyes and curve the image through 90° and turn head to view. Alternatively, the visualisation can be laid flat and viewed by scanning left or right parallel to the sheet maintaining a 50cm viewing distance between your eye and the page.

This visualisation is a tool for assessment and is best used for comparison in the field from the viewpoint location shown. It cannot be considered a substitute for visiting the viewpoint location.

**Technical Information**

Refer to accompanying Technical Methodology.

**Printing Note**

This viewpoint visualisation is spread across a single sheet 841mm wide and 297mm high. To give the correct viewing distance the sheet should be printed at a scale of 1:1 on large format paper and cut to size. Do not print at A3.

**Viewpoint Direction**

The centre of this viewpoint is facing North East.

**West Burton Solar Project**

Viewpoint 72 (LCC-O) - Existing Winter View

Figure 8.13.72a





Extent of 50mm Single Frame Image



**Viewing Information**

This photograph and visualisation is a cylindrical projection panorama. Hold this sheet at a comfortable arm's length from your eyes and curve the image through 90° and turn head to view. Alternatively, the visualisation can be laid flat and viewed by scanning left or right parallel to the sheet maintaining a 50cm viewing distance between your eye and the page.

This visualisation is a tool for assessment and is best used for comparison in the field from the viewpoint location shown. It cannot be considered a substitute for visiting the viewpoint location.

**Technical Information**

Refer to accompanying Technical Methodology.

**Printing Note**

This viewpoint visualisation is spread across a single sheet 841mm wide and 297mm high. To give the correct viewing distance the sheet should be printed at a scale of 1:1 on large format paper and cut to size. Do not print at A3.

**Viewpoint Direction**

The centre of this viewpoint is facing South East.

**West Burton Solar Project**

Viewpoint 72 (LCC-O) - Existing Winter View  
Figure 8.13.72a





#### Viewing Information

This photograph and visualisation is a cylindrical projection panorama. Hold this sheet at a comfortable arm's length from your eyes and curve the image through 90° and turn head to view. Alternatively, the visualisation can be laid flat and viewed by scanning left or right parallel to the sheet maintaining a 50cm viewing distance between your eye and the page.

This visualisation is a tool for assessment and is best used for comparison in the field from the viewpoint location shown. It cannot be considered a substitute for visiting the viewpoint location.

#### Technical Information

Refer to accompanying Technical Methodology.

#### Printing Note

This viewpoint visualisation is spread across a single sheet 841mm wide and 297mm high. To give the correct viewing distance the sheet should be printed at a scale of 1:1 on large format paper and cut to size. Do not print at A3.

#### Viewpoint Direction

The centre of this viewpoint is facing South West.

## West Burton Solar Project

Viewpoint 72 (LCC-O) - Existing Winter View  
Figure 8.13.72a





#### Viewing Information

This photograph and visualisation is a cylindrical projection panorama. Hold this sheet at a comfortable arm's length from your eyes and curve the image through 90° and turn head to view. Alternatively, the visualisation can be laid flat and viewed by scanning left or right parallel to the sheet maintaining a 50cm viewing distance between your eye and the page.

This visualisation is a tool for assessment and is best used for comparison in the field from the viewpoint location shown. It cannot be considered a substitute for visiting the viewpoint location.

#### Technical Information

Refer to accompanying Technical Methodology.

#### Printing Note

This viewpoint visualisation is spread across a single sheet 841mm wide and 297mm high. To give the correct viewing distance the sheet should be printed at a scale of 1:1 on large format paper and cut to size. Do not print at A3.

#### Viewpoint Direction

The centre of this viewpoint is facing North West.

## West Burton Solar Project

Viewpoint 72 (LCC-O) - Existing Winter View  
Figure 8.13.72a





**Viewing Information**

This photograph and visualisation is a cylindrical projection panorama. Hold this sheet at a comfortable arm's length from your eyes and curve the image through 90° and turn head to view. Alternatively, the visualisation can be laid flat and viewed by scanning left or right parallel to the sheet maintaining a 50cm viewing distance between your eye and the page.

This visualisation is a tool for assessment and is best used for comparison in the field from the viewpoint location shown. It cannot be considered a substitute for visiting the viewpoint location.

**Technical Information**

Refer to accompanying Technical Methodology.

**Printing Note**

This viewpoint visualisation is spread across a single sheet 841mm wide and 297mm high. To give the correct viewing distance the sheet should be printed at a scale of 1:1 on large format paper and cut to size. Do not print at A3.

**Viewpoint Direction**

The centre of this viewpoint is facing North East.

# West Burton Solar Project

Viewpoint 72 (LCC-O) - Existing Summer View

Figure 8.13.72b





Extent of 50mm Single Frame Image



**Viewing Information**

This photograph and visualisation is a cylindrical projection panorama. Hold this sheet at a comfortable arm's length from your eyes and curve the image through 90° and turn head to view. Alternatively, the visualisation can be laid flat and viewed by scanning left or right parallel to the sheet maintaining a 50cm viewing distance between your eye and the page.

This visualisation is a tool for assessment and is best used for comparison in the field from the viewpoint location shown. It cannot be considered a substitute for visiting the viewpoint location.

**Technical Information**

Refer to accompanying Technical Methodology.

**Printing Note**

This viewpoint visualisation is spread across a single sheet 841mm wide and 297mm high. To give the correct viewing distance the sheet should be printed at a scale of 1:1 on large format paper and cut to size. Do not print at A3.

**Viewpoint Direction**

The centre of this viewpoint is facing South East.

**West Burton Solar Project**

Viewpoint 72 (LCC-O) - Existing Summer View

Figure 8.13.72b





#### Viewing Information

This photograph and visualisation is a cylindrical projection panorama. Hold this sheet at a comfortable arm's length from your eyes and curve the image through 90° and turn head to view. Alternatively, the visualisation can be laid flat and viewed by scanning left or right parallel to the sheet maintaining a 50cm viewing distance between your eye and the page.

This visualisation is a tool for assessment and is best used for comparison in the field from the viewpoint location shown. It cannot be considered a substitute for visiting the viewpoint location.

#### Technical Information

Refer to accompanying Technical Methodology.

#### Printing Note

This viewpoint visualisation is spread across a single sheet 841mm wide and 297mm high. To give the correct viewing distance the sheet should be printed at a scale of 1:1 on large format paper and cut to size. Do not print at A3.

#### Viewpoint Direction

The centre of this viewpoint is facing South West.

## West Burton Solar Project

Viewpoint 72 (LCC-O) - Existing Summer View

Figure 8.13.72b





#### Viewing Information

This photograph and visualisation is a cylindrical projection panorama. Hold this sheet at a comfortable arm's length from your eyes and curve the image through 90° and turn head to view. Alternatively, the visualisation can be laid flat and viewed by scanning left or right parallel to the sheet maintaining a 50cm viewing distance between your eye and the page.

This visualisation is a tool for assessment and is best used for comparison in the field from the viewpoint location shown. It cannot be considered a substitute for visiting the viewpoint location.

#### Technical Information

Refer to accompanying Technical Methodology.

#### Printing Note

This viewpoint visualisation is spread across a single sheet 841mm wide and 297mm high. To give the correct viewing distance the sheet should be printed at a scale of 1:1 on large format paper and cut to size. Do not print at A3.

#### Viewpoint Direction

The centre of this viewpoint is facing North West.

## West Burton Solar Project

Viewpoint 72 (LCC-O) - Existing Summer View

Figure 8.13.72b



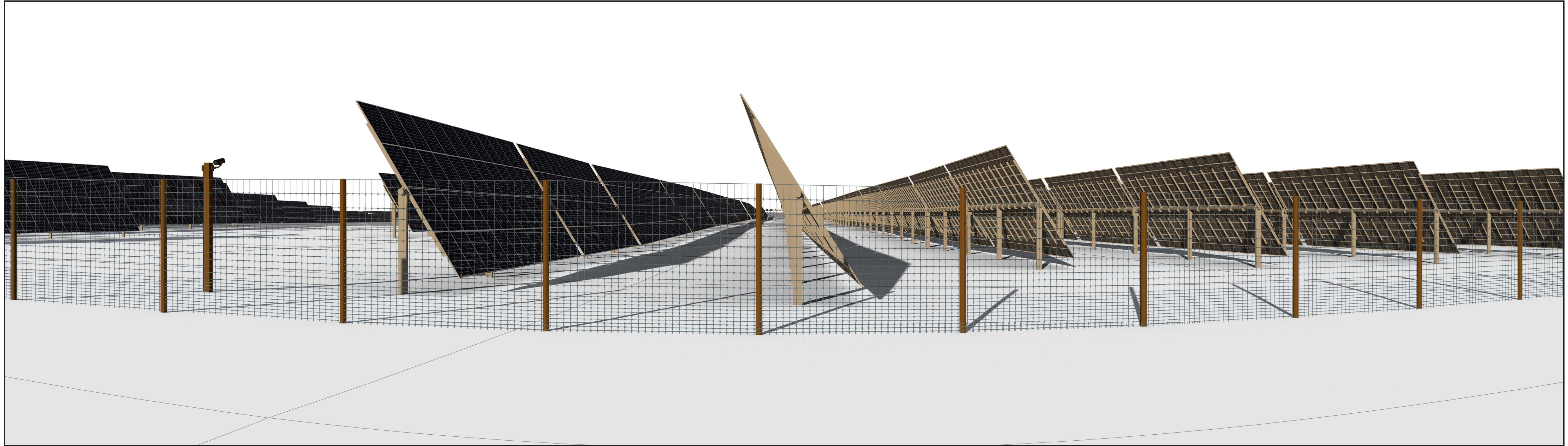

#### Viewing Information

This photograph and visualisation is a cylindrical projection panorama. Hold this sheet at a comfortable arm's length from your eyes and curve the image through 90° and turn head to view. Alternatively, the visualisation can be laid flat and viewed by scanning left or right parallel to the sheet maintaining a 50cm viewing distance between your eye and the page.

This visualisation is a tool for assessment and is best used for comparison in the field from the viewpoint location shown. It cannot be considered a substitute for visiting the viewpoint location.

#### Technical Information

Refer to accompanying Technical Methodology.

#### Printing Note

This viewpoint visualisation is spread across a single sheet 841mm wide and 297mm high. To give the correct viewing distance the sheet should be printed at a scale of 1:1 on large format paper and cut to size. Do not print at A3.

#### Viewpoint Direction

The centre of this viewpoint is facing North East.

## West Burton Solar Project

Viewpoint 72 (LCC-O) - Infrastructure Model View

Figure 8.13.72c



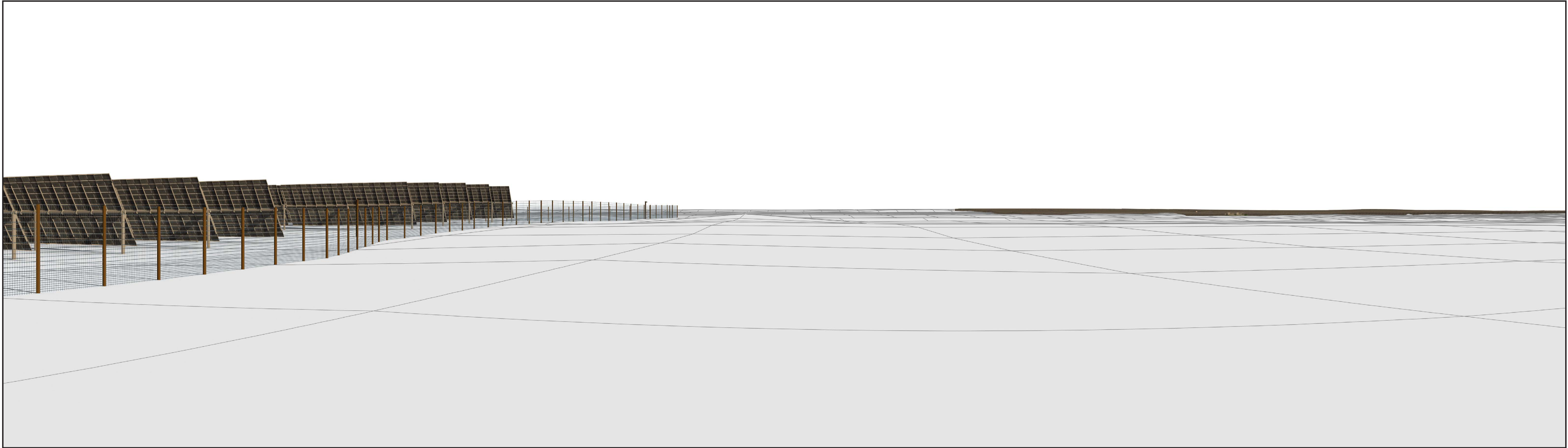

**Viewing Information**

This photograph and visualisation is a cylindrical projection panorama. Hold this sheet at a comfortable arm's length from your eyes and curve the image through 90° and turn head to view. Alternatively, the visualisation can be laid flat and viewed by scanning left or right parallel to the sheet maintaining a 50cm viewing distance between your eye and the page.

This visualisation is a tool for assessment and is best used for comparison in the field from the viewpoint location shown. It cannot be considered a substitute for visiting the viewpoint location.

**Technical Information**

Refer to accompanying Technical Methodology.

**Printing Note**

This viewpoint visualisation is spread across a single sheet 841mm wide and 297mm high. To give the correct viewing distance the sheet should be printed at a scale of 1:1 on large format paper and cut to size. Do not print at A3.

**Viewpoint Direction**

The centre of this viewpoint is facing South East.

**West Burton Solar Project**

Viewpoint 72 (LCC-O) - Infrastructure Model View

Figure 8.13.72c



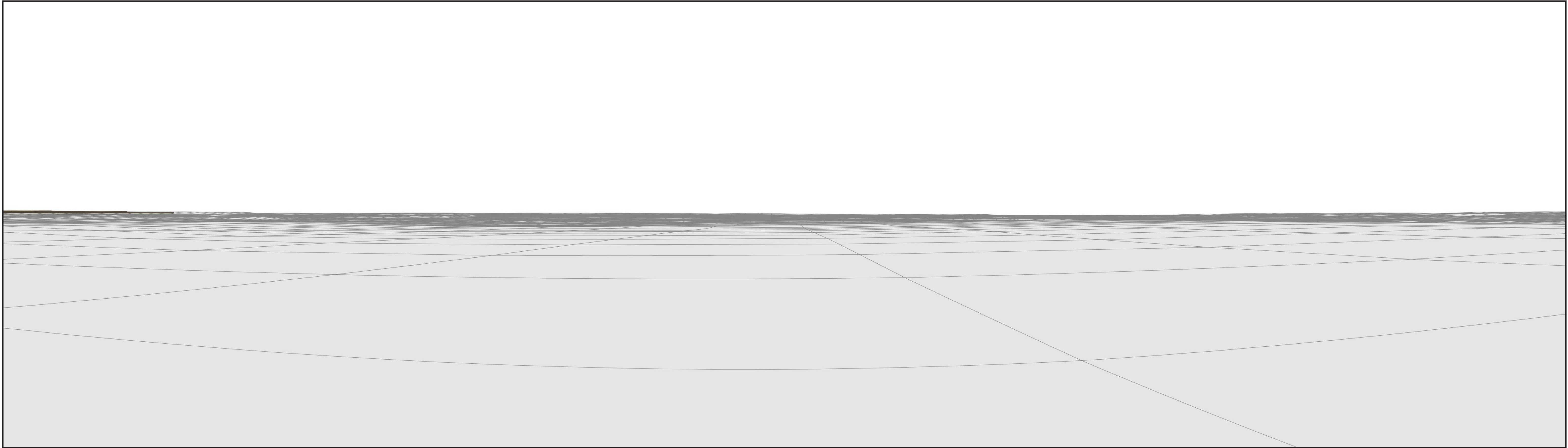

**Viewing Information**

This photograph and visualisation is a cylindrical projection panorama. Hold this sheet at a comfortable arm's length from your eyes and curve the image through 90° and turn head to view. Alternatively, the visualisation can be laid flat and viewed by scanning left or right parallel to the sheet maintaining a 50cm viewing distance between your eye and the page.

This visualisation is a tool for assessment and is best used for comparison in the field from the viewpoint location shown. It cannot be considered a substitute for visiting the viewpoint location.

**Technical Information**

Refer to accompanying Technical Methodology.

**Printing Note**

This viewpoint visualisation is spread across a single sheet 841mm wide and 297mm high. To give the correct viewing distance the sheet should be printed at a scale of 1:1 on large format paper and cut to size. Do not print at A3.

**Viewpoint Direction**

The centre of this viewpoint is facing South West.

**West Burton Solar Project**

Viewpoint 72 (LCC-O) - Infrastructure Model View

Figure 8.13.72c



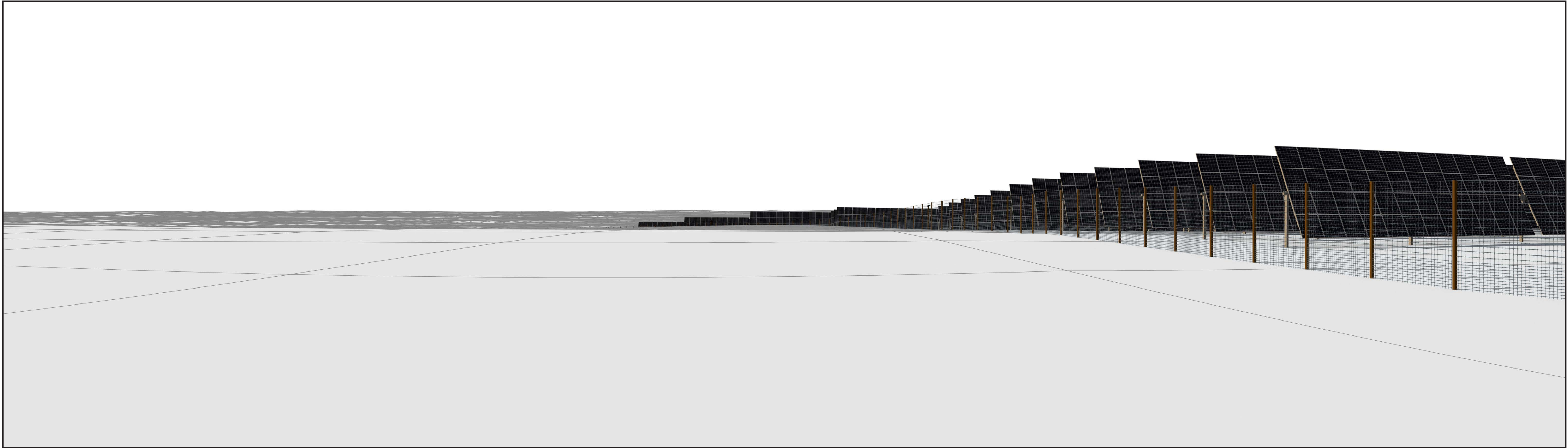

**Viewing Information**

This photograph and visualisation is a cylindrical projection panorama. Hold this sheet at a comfortable arm's length from your eyes and curve the image through 90° and turn head to view. Alternatively, the visualisation can be laid flat and viewed by scanning left or right parallel to the sheet maintaining a 50cm viewing distance between your eye and the page.

This visualisation is a tool for assessment and is best used for comparison in the field from the viewpoint location shown. It cannot be considered a substitute for visiting the viewpoint location.

**Technical Information**

Refer to accompanying Technical Methodology.

**Printing Note**

This viewpoint visualisation is spread across a single sheet 841mm wide and 297mm high. To give the correct viewing distance the sheet should be printed at a scale of 1:1 on large format paper and cut to size. Do not print at A3.

**Viewpoint Direction**

The centre of this viewpoint is facing North West.

# West Burton Solar Project

Viewpoint 72 (LCC-O) - Infrastructure Model View

Figure 8.13.72c





**Viewing Information**

This photograph and visualisation is a cylindrical projection panorama. Hold this sheet at a comfortable arm's length from your eyes and curve the image through 90° and turn head to view. Alternatively, the visualisation can be laid flat and viewed by scanning left or right parallel to the sheet maintaining a 50cm viewing distance between your eye and the page.

This visualisation is a tool for assessment and is best used for comparison in the field from the viewpoint location shown. It cannot be considered a substitute for visiting the viewpoint location.

**Technical Information**

Refer to accompanying Technical Methodology.

**Printing Note**

This viewpoint visualisation is spread across a single sheet 841mm wide and 297mm high. To give the correct viewing distance the sheet should be printed at a scale of 1:1 on large format paper and cut to size. Do not print at A3.

**Viewpoint Direction**

The centre of this viewpoint is facing North East.

# West Burton Solar Project

Viewpoint 72 (LCC-O) - Winter AVR3 (Year 1)

Figure 8.13.72d





#### Viewing Information

This photograph and visualisation is a cylindrical projection panorama. Hold this sheet at a comfortable arm's length from your eyes and curve the image through 90° and turn head to view. Alternatively, the visualisation can be laid flat and viewed by scanning left or right parallel to the sheet maintaining a 50cm viewing distance between your eye and the page.

This visualisation is a tool for assessment and is best used for comparison in the field from the viewpoint location shown. It cannot be considered a substitute for visiting the viewpoint location.

#### Technical Information

Refer to accompanying Technical Methodology.

#### Printing Note

This viewpoint visualisation is spread across a single sheet 841mm wide and 297mm high. To give the correct viewing distance the sheet should be printed at a scale of 1:1 on large format paper and cut to size. Do not print at A3.

#### Viewpoint Direction

The centre of this viewpoint is facing South East.

## West Burton Solar Project

Viewpoint 72 (LCC-O) - Winter AVR3 (Year 1)

Figure 8.13.72d





#### Viewing Information

This photograph and visualisation is a cylindrical projection panorama. Hold this sheet at a comfortable arm's length from your eyes and curve the image through 90° and turn head to view. Alternatively, the visualisation can be laid flat and viewed by scanning left or right parallel to the sheet maintaining a 50cm viewing distance between your eye and the page.

This visualisation is a tool for assessment and is best used for comparison in the field from the viewpoint location shown. It cannot be considered a substitute for visiting the viewpoint location.

#### Technical Information

Refer to accompanying Technical Methodology.

#### Printing Note

This viewpoint visualisation is spread across a single sheet 841mm wide and 297mm high. To give the correct viewing distance the sheet should be printed at a scale of 1:1 on large format paper and cut to size. Do not print at A3.

#### Viewpoint Direction

The centre of this viewpoint is facing South West.

## West Burton Solar Project

Viewpoint 72 (LCC-O) - Winter AVR3 (Year 1)

Figure 8.13.72d





#### Viewing Information

This photograph and visualisation is a cylindrical projection panorama. Hold this sheet at a comfortable arm's length from your eyes and curve the image through 90° and turn head to view. Alternatively, the visualisation can be laid flat and viewed by scanning left or right parallel to the sheet maintaining a 50cm viewing distance between your eye and the page.

This visualisation is a tool for assessment and is best used for comparison in the field from the viewpoint location shown. It cannot be considered a substitute for visiting the viewpoint location.

#### Technical Information

Refer to accompanying Technical Methodology.

#### Printing Note

This viewpoint visualisation is spread across a single sheet 841mm wide and 297mm high. To give the correct viewing distance the sheet should be printed at a scale of 1:1 on large format paper and cut to size. Do not print at A3.

#### Viewpoint Direction

The centre of this viewpoint is facing North West.

## West Burton Solar Project

Viewpoint 72 (LCC-O) - Winter AVR3 (Year 1)

Figure 8.13.72d





#### Viewing Information

This photograph and visualisation is a cylindrical projection panorama. Hold this sheet at a comfortable arm's length from your eyes and curve the image through 90° and turn head to view. Alternatively, the visualisation can be laid flat and viewed by scanning left or right parallel to the sheet maintaining a 50cm viewing distance between your eye and the page.

This visualisation is a tool for assessment and is best used for comparison in the field from the viewpoint location shown. It cannot be considered a substitute for visiting the viewpoint location.

#### Technical Information

Refer to accompanying Technical Methodology.

#### Printing Note

This viewpoint visualisation is spread across a single sheet 841mm wide and 297mm high. To give the correct viewing distance the sheet should be printed at a scale of 1:1 on large format paper and cut to size. Do not print at A3.

#### Viewpoint Direction

The centre of this viewpoint is facing North East.

## West Burton Solar Project

Viewpoint 72 (LCC-O) - Summer AVR3 (Year 15)

Figure 8.13.72e





**Viewing Information**

This photograph and visualisation is a cylindrical projection panorama. Hold this sheet at a comfortable arm's length from your eyes and curve the image through 90° and turn head to view. Alternatively, the visualisation can be laid flat and viewed by scanning left or right parallel to the sheet maintaining a 50cm viewing distance between your eye and the page.

This visualisation is a tool for assessment and is best used for comparison in the field from the viewpoint location shown. It cannot be considered a substitute for visiting the viewpoint location.

**Technical Information**

Refer to accompanying Technical Methodology.

**Printing Note**

This viewpoint visualisation is spread across a single sheet 841mm wide and 297mm high. To give the correct viewing distance the sheet should be printed at a scale of 1:1 on large format paper and cut to size. Do not print at A3.

**Viewpoint Direction**

The centre of this viewpoint is facing South East.

# West Burton Solar Project

Viewpoint 72 (LCC-O) - Summer AVR3 (Year 15)

Figure 8.13.72e





#### Viewing Information

This photograph and visualisation is a cylindrical projection panorama. Hold this sheet at a comfortable arm's length from your eyes and curve the image through 90° and turn head to view. Alternatively, the visualisation can be laid flat and viewed by scanning left or right parallel to the sheet maintaining a 50cm viewing distance between your eye and the page.

This visualisation is a tool for assessment and is best used for comparison in the field from the viewpoint location shown. It cannot be considered a substitute for visiting the viewpoint location.

#### Technical Information

Refer to accompanying Technical Methodology.

#### Printing Note

This viewpoint visualisation is spread across a single sheet 841mm wide and 297mm high. To give the correct viewing distance the sheet should be printed at a scale of 1:1 on large format paper and cut to size. Do not print at A3.

#### Viewpoint Direction

The centre of this viewpoint is facing South West.

## West Burton Solar Project

Viewpoint 72 (LCC-O) - Summer AVR3 (Year 15)

Figure 8.13.72e





**Viewing Information**

This photograph and visualisation is a cylindrical projection panorama. Hold this sheet at a comfortable arm's length from your eyes and curve the image through 90° and turn head to view. Alternatively, the visualisation can be laid flat and viewed by scanning left or right parallel to the sheet maintaining a 50cm viewing distance between your eye and the page.

This visualisation is a tool for assessment and is best used for comparison in the field from the viewpoint location shown. It cannot be considered a substitute for visiting the viewpoint location.

**Technical Information**

Refer to accompanying Technical Methodology.

**Printing Note**

This viewpoint visualisation is spread across a single sheet 841mm wide and 297mm high. To give the correct viewing distance the sheet should be printed at a scale of 1:1 on large format paper and cut to size. Do not print at A3.

**Viewpoint Direction**

The centre of this viewpoint is facing North West.

**West Burton Solar Project**

Viewpoint 72 (LCC-O) - Summer AVR3 (Year 15)

Figure 8.13.72e